



You will need

- 3 x embroidery rings
- 3 x bowls or plant pots to fit inside the embroidery rings
- 3 x 4mm bolts with nuts
- 2m of chain
- 3 x hooks
- Your choice of Resene finish
Resene Altex Timbercote Exterior Varnish

Tools:

- Measure tape and pencil
- Ruler
- Drill with 4mm drill bit
- Pliers
- File
- Paintbrushes

Health & safety When using power tools always wear goggles and ear defenders, and ensure all jewellery is tucked away, hair tied back and don't wear loose clothing that may get tangled.

Cost \$30. This excludes Resene products. I used Resene Koru and Woodland, and top coated with Resene Altex Timbercote Exterior Varnish.

Hanging circle planters

This is an inside project for these colder winter months. These hangers can be for inside or outside use.

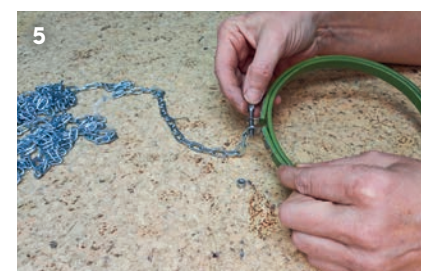
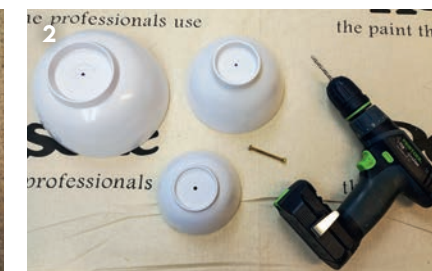

Step 1

Paint each ring with your Resene colour choice. I have used Resene Koru and Woodland, and left one ring natural.

Once dry, top coat with Resene Altex Timbercote Exterior Varnish as per the manufacturer's instructions.

Step 2

Drill a hole in the centre of each bowl with a 4mm drill bit, to enable the bolt to fit through with ease.

Step 3

File straight across the bottom of the bowl, if required, to make a groove for the embroidery ring to sit in for better stability.

Step 4

Measure straight down from top to bottom of each embroidery ring, and make a mark at the bottom of each

ring where the bolt hole will go. Drill a 4mm hole through the bottom of the ring.

Step 5

Undo the fixing at the top of the embroidery ring and attached the metal chain, and tighten back up.

Cut the chain to the required length with pliers.

Step 6

Thread the bolt through the bottom of the ring and into the bowl. Add the nut and tighten to suit.

Step 7

I used Oasis floral foam in my bowls as it is lightweight. Put in your plants or flowers.

Make sure your hooks have a good fixing in the ceiling before hanging your planters. ■



Jane Horne and partner Simon Bartholomew design and develop projects from their studio (plainandsimple.co.nz) in Christchurch, managing projects throughout the South Island.