



kids 'n' dirt



TERRACOTTA WINDCHIME

Kids will have fun decorating these pots and you'll be able to hang them up to show off their colourful artwork.

WORDS ALICE BUSH
PHOTOS LOUISE BUSH

OUR COLOURS

- Resene Adrenalin
- Resene Bright Spark
- Resene Wellywood
- Resene Havoc

You will need

- Terracotta pots of different sizes (as many as you like)
- Resene Terracotta Sealer
- Resene testpots
- Drop cloth or newspaper to protect your work surface
- Paint brushes
- Rope 8mm width, the rope needs to be thin enough to fit through the hole in the bottom of the pot but wide enough that when you tie a knot it doesn't slip out.
- Washers 3-4



Another idea:

You can make this with as many pots as you would like, just continue repeating the steps. Try going from smallest to biggest or experiment for yourself!

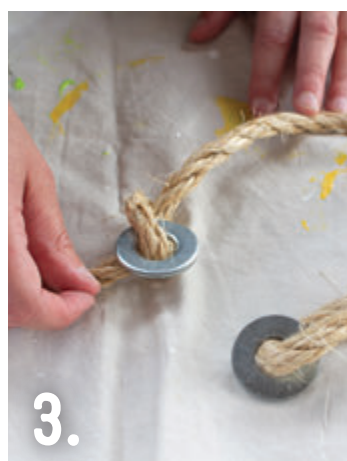
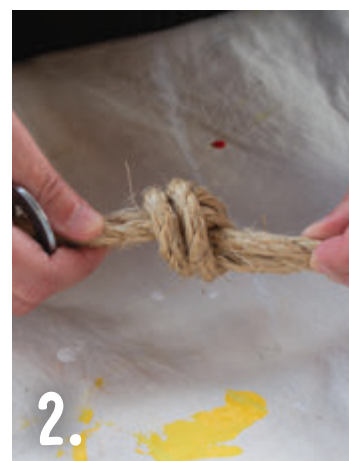

Something pretty

Why not try adding colourful beads to your pots to shine in the sun. Glue these on or attach them to your rope!

BEFORE YOU START

This could be a great opportunity to use up some of those old pots hanging around the garden, wash old pots of dirt if needed. Make sure all your pots, old and new have a hole in the bottom or else the rope won't fit through.

For best durability, first seal the terracotta pots inside and out with Resene Terracotta Sealer.

STEP 1

Then paint pots with your chosen colours, we used Resene Adrenalin, Resene Bright Spark, Resene Wellywood and Resene Havoc. Have fun with this, get creative with different colours and patterns. Kids can paint their own funky designs. Wait for the paint to dry.

STEP 2

Tie a loop knot in one end of the rope. You can place something inside the loop, such as beads, sea shells or an extra washer. This provides a bit of weight at the end of the rope and something to pull on when you want the chime to make noise.

STEP 3

Measure along the length of your rope about 30-40cm. At this spot tie a knot with a washer in the middle. This will hang inside of the first pot like a bell.

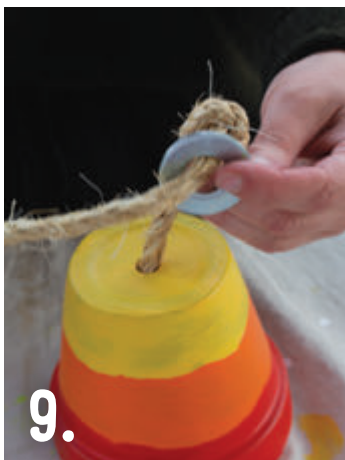

STEP 4

Measure against the side of the smallest pot. Note with your fingers where the bottom of the pot sits against the rope. Making sure the washer knot you made in step 3 is inside the pot.

STEP 5

Tie a knot where you have noted.

STEP 6

Thread a washer through the rope until it sits on top of this knot.

STEP 7

Follow the washer with your smallest pot.

STEP 8

Repeat with next pot, making sure to measure so the pot already on the rope will be inside the slightly larger pot.

STEP 9

Tie a knot in the rope where noted and thread a washer through, followed by the pot.

STEP 10

Once your wind chime is done hang it from a tree, pagoda, overhang or off the side of your house. Thread the excess rope over your chosen place before tying it securely. Cut off any extra rope.

Paint tips

- Get every family member to choose their favourite colour and paint a pot each. Remember to invite your extended family to help too.
- Use Resene FX Metallic paint for a shimmery metallic finish that will glisten in the sunlight.
- Paint designs onto selected pots using Resene FX Nightlight for a cool glow-in-the-dark effect.

BROUGHT TO YOU BY



the paint the professionals use