

make a bin locker

Wheelie bins are a practical fact of life in many of our cities and towns... but they're not the most attractive of items. Here's a smart way to keep them out of sight.

Final

You will need:

- 100mm x 100mm dressed H4 treated post for the corner (1.8m long)
- 75mm x 50mm dressed H3 treated timber for vertical framing of gates and side panel (6m)
- 100mm x 40mm dressed H3 treated timber for horizontal framing (5m)
- 90mm x 50mm dressed H3 treated timber to fix gate to house (1.2m)
- Dressed H3 treated palings – we used 20m each of 50mm x 25mm and 75mm x 25mm for our contemporary look but you can use just one size if you prefer
- Stainless steel screws – 1 pack of 50mm square head and 1 pack of 75mm square head
- Coach screws for fixing to the house and existing post
- 25kg bag of rapid-set concrete
- 4 galvanised hinges and screws
- Gate lock and screws
- Resene Lumbersider tinted to your desired colour – we used Resene Silver Sand

Tools, from Hirepool: post-hole borer; mitre saw; circular saw; battery-powered drill and bits; belt sander and 80-grit paper; trowel; spirit level; four clamps; extension cord; ear plugs; safety glasses.

pictures Mark Heaslip



Step 1

Decide on your paling pattern. We used two widths of paling and set them over two different heights. Bore a hole for the corner post and concrete in. Leave to set. Measure and cut the timber, and pre-paint.

Step 4

Drill and screw one of the gates to the main post then drill and screw the other gate to the smaller post and attach to the house.

Step 2

Make up the side panel frame and attach the palings. Make the two gates and attach the gate hinges.

Step 5

Clamp the gates together then attach the gate lock.

Step 3

Drill and screw the side panel to the corner post and any existing structure using clamps to steady it – in this case it's the house and a veranda post.

Resene Silver Sand 

Resene Friar Grey 

Resene Quarter Spanish White 

Resene Origin 

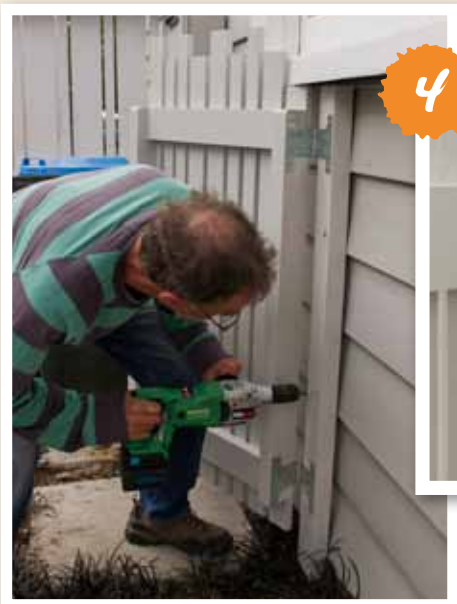
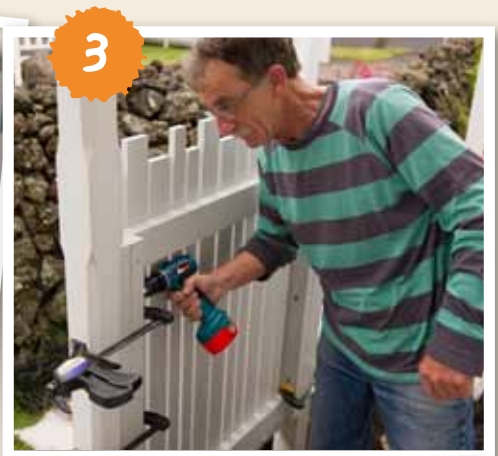
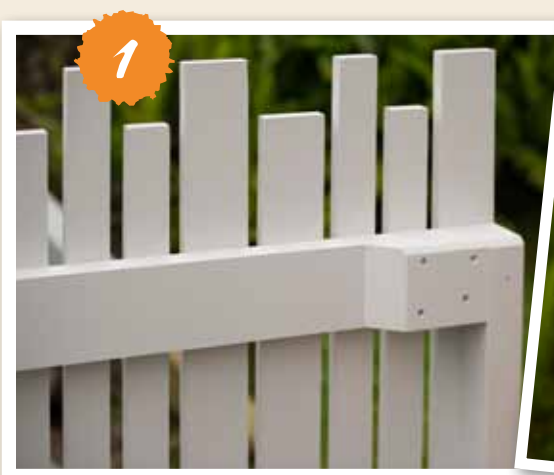

All equipment and expertise from Hirepool. Visit www.hirepool.co.nz or call 0800 HIREPOOL.

